

AMPLASAMENT

# SUPTO TOPOGRAFIC

Scara 1:200

JUDETUL PRAHOVA  
UNITATEA ADMINISTRATIV TERITORIALA: CORNU  
ADRESA IMOBIL: COM. CORNU, SAT CORNU DE JOS  
STR. POMILOR intersectie cu STR. VALEA REA-INTRAVILAN  
PROPRIETAR: JUDETUL PRAHOVA - Domeniu public  
COMUNA CORNU - Domeniu public  
BENEFICIAR: COMUNA CORNU

Nota: Suprafata Studiata = 917 mp

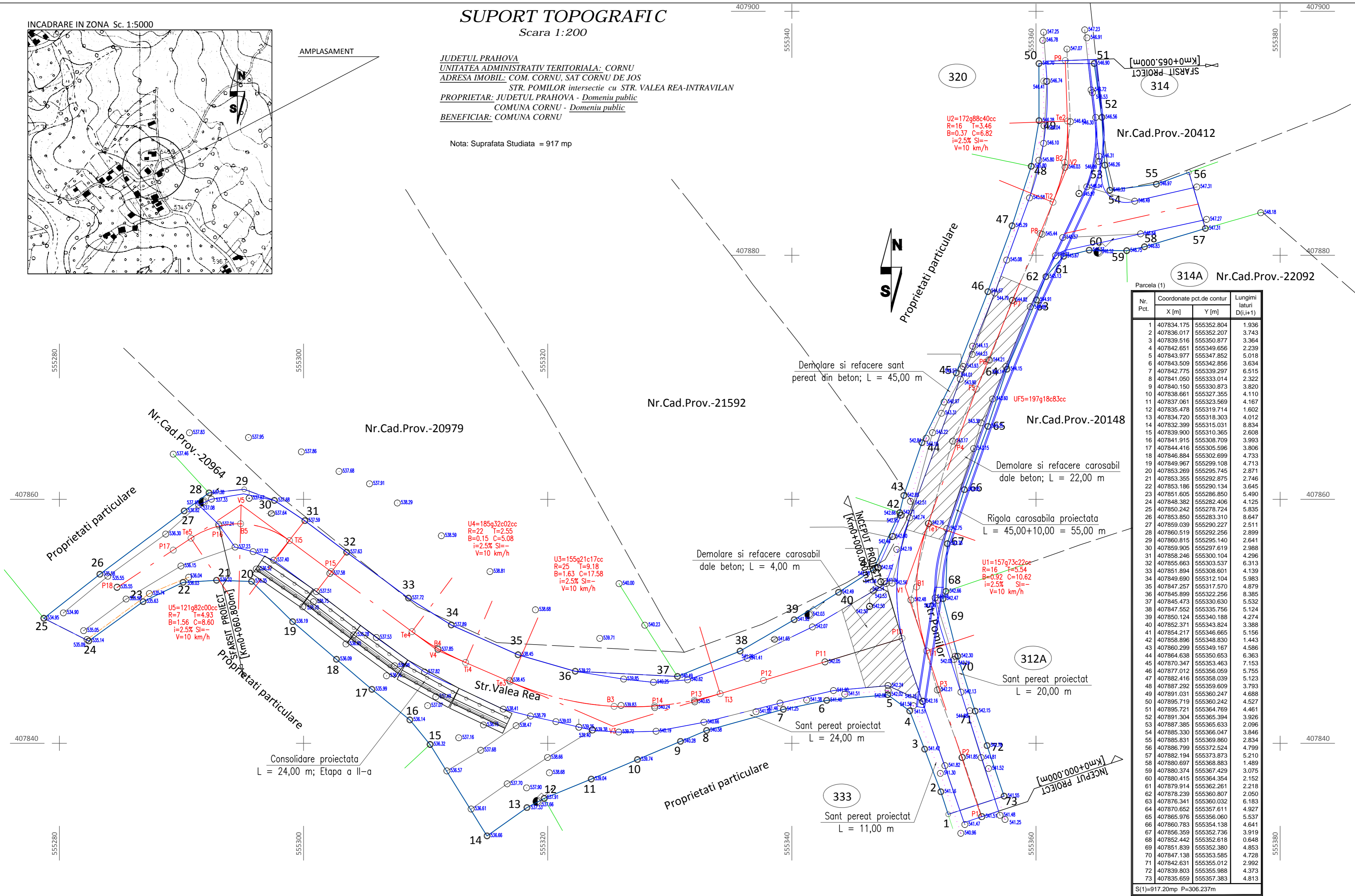

Nr. Pct.	Coordonate pct.de contur		Lungimi laturi D(i,i+1)
	X [m]	Y [m]	
1	407834.175	555352.804	1.936
2	407836.017	555352.207	3.743
3	407839.516	555350.877	3.364
4	407842.651	555349.656	2.239
5	407843.977	555347.852	5.018
6	407843.509	555342.856	6.334
7	407842.775	555339.297	6.515
8	407841.050	555333.014	2.322
9	407840.150	555330.873	3.820
10	407837.661	555327.355	4.110
11	407837.061	555323.569	4.167
12	407835.478	555319.714	1.602
13	407834.720	555318.303	4.012
14	407832.399	555315.031	8.834
15	407839.900	555310.365	2.608
16	407841.915	555308.709	3.993
17	407844.416	555305.596	3.806
18	407846.884	555302.699	4.733
19	407849.967	555299.108	4.713
20	407853.269	555295.745	2.871
21	407853.355	555292.875	2.746
22	407853.186	555290.134	3.645
23	407851.605	555286.850	5.490
24	407848.382	555282.406	4.125
25	407850.242	555278.724	5.835
26	407853.850	555283.310	8.647
27	407859.039	555290.227	2.511
28	407860.519	555292.256	2.899
29	407860.815	555295.140	2.641
30	407859.905	555297.619	2.988
31	407858.246	555300.104	4.296
32	407855.663	555303.537	6.313
33	407851.894	555308.601	4.139
34	407849.690	555312.104	5.983
35	407847.257	555317.570	4.879
36	407845.899	555322.256	8.385
37	407845.473	555330.630	5.532
38	407847.552	555335.756	5.124
39	407850.124	555340.188	4.274
40	407852.371	555343.824	3.388
41	407854.217	555346.665	5.156
42	407858.896	555348.830	1.443
43	407860.299	555349.167	4.586
44	407864.638	555350.653	6.363
45	407870.347	555353.463	7.153
46	407877.012	555356.059	5.755
47	407882.416	555358.039	5.123
48	407887.292	555359.609	3.793
49	407891.031	555360.247	4.688
50	407895.719	555360.242	4.527
51	407895.721	555364.769	4.461
52	407891.304	555365.394	3.926
53	407887.385	555365.633	2.096
54	407885.330	555366.047	3.846
55	407885.831	555369.860	2.834
56	407886.799	555372.524	4.799
57	407882.194	555373.873	5.210
58	407880.697	555368.883	1.489
59	407880.374	555367.429	3.075
60	407880.415	555364.354	2.152
61	407879.914	555362.261	2.218
62	407878.239	555360.807	2.050
63	407876.341	555360.032	6.183
64	407870.652	555357.611	4.927
65	407865.976	555356.060	5.537
66	407860.783	555354.138	4.641
67	407856.359	555352.736	3.919
68	407852.442	555352.618	0.648
69	407851.839	555352.380	4.853
70	407847.138	555353.585	4.728
71	407842.631	555355.012	2.992
72	407839.803	555355.988	4.373
73	407835.659	555357.383	4.813

S(1)=917.20mp P=306.237m

Proiectant specialitate S.C. RUTCONSULT S.R.L. PLOIESTI J29/1698/2006			CONSOLIDARE STRADA POMILOR PUNCT STOIAN – ALEEA VALEA REA COMUNA CORNU – JUDETUL PRAHOVA Beneficiar: Comuna Cornu		PR. NR. 102/2015 FAZA: PT+DE+CS
SPECIFICATIE	NUME	SEMNAURA	SCARA:	PLAN DE SITUATIE	PLANSA
SEF PROIECT	IONITA MARIA		1:200	STRADA POMILOR	2
PROIECTAT	IONITA MARIA			Km 0+000.00 – Km 0+065.00	
DESEENAT	IONITA MARIA			STRADA ALEEA VALEA REA Km 0+000.00 – Km 0+060.80	